

Pool Carton Breakdown – Atlantis 48 NB1010

PV18361530

**ESPRIT PW T 48 1530 HARMONY
CHANNEL LOK II OVAL**

Features: Oval
Size: 15' x 30'
Depth: 48"

Steel textured top rails
Wall with protectoloc finish
Galvanized steel bottom rails
Slotted tube stabilizers

| | Carton Part No. | Carton Description | Carton Qty. |
|--------------------------|-------------------|--|-------------|
| <input type="checkbox"/> | 301530652 | 1530' x 48" ESPRIT P/W T FR PK CHLK II | 1 |
| <input type="checkbox"/> | 3901480620 | 48" P/W T CH LOK II MID PK-06PK | 1 |
| <input type="checkbox"/> | 36153010 | 1530' CH LOK II STRAP PACK | 1 |

| | Wall Part No. | Wall Description | Carton Qty. |
|--------------------------|------------------|--------------------------------|-------------|
| <input type="checkbox"/> | 381530144 | 1530' x 48" HARMONY 12S 2-1/2R | 1 |

ATLANTIS 48" OVAL

(Manuf. Name: ESPRIT CHANNEL LOK II)

NB1010 15'x30' Oval

COMPONENTS - FOUND IN FRAME PACK (301530652)

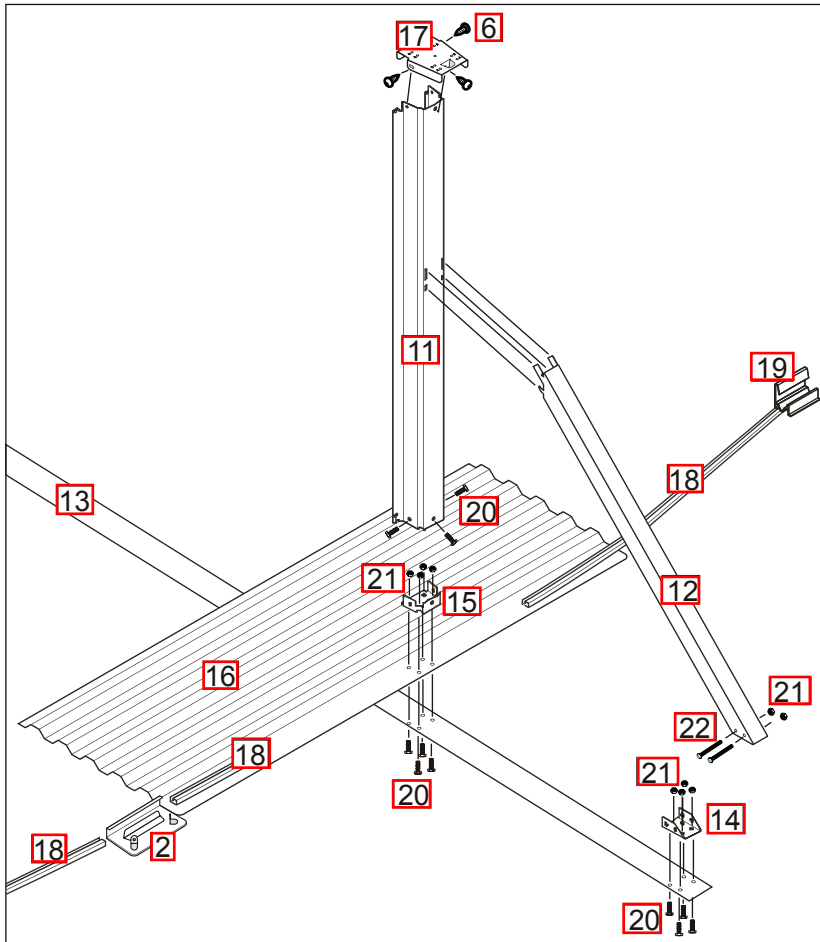

| PART # | DESCRIPTION | KEY # | 12 x 18' | 12 x 24' | 15 x 24' | 15 x 30' | 18 x 33' |
|---------|----------------------------------|---------|----------|----------|----------|----------|----------|
| 1450299 | 12' Top Rail | 7 | 8 | 8 | | | |
| 1450301 | Common Length | 7 | | | 8 | 8 | 10 |
| 1450658 | Transition Rail x 47" | 7 | | 8 | | | |
| 1450659 | Transition Rail x 58-1/4" | 7 | 4 | | 4 | 4 | 4 |
| 1450656 | Straight Rail x 47-1/4" | 7 | | 8 | 2 | | |
| 1450657 | Straight Rail x 58-3/4" | 7 | | | | 4 | 4 |
| 1440140 | Vertical x 47-1/2" | 1 | 8 | 8 | 8 | 8 | 10 |
| 1320102 | Top Plate | 4 | 8 | 8 | 8 | 8 | 10 |
| 1320160 | Side Top Plate | 17 | 2 | 6 | 4 | 6 | 6 |
| 1320101 | Base Plate | 2 | 8 | 8 | 8 | 8 | 10 |
| 1470108 | Slotted Tube Conn. | | 10 | 10 | 10 | 10 | 12 |
| 1470087 | Resin Slotted Tube Conn. | | 2 | 6 | 4 | 6 | 6 |
| 1490494 | Rail Support | 19 | | 4 | 2 | 4 | 4 |
| 1470096 | Slotted Tube x 44" | | 8 | 8 | | | |
| 1470097 | Slotted Tube x 55-1/2" | | | | 8 | 8 | |
| 1470098 | Slotted Tube x 55-1/4" (Yellow) | | 4 | | | | |
| 1470098 | Slotted Tube x 55-1/4" (Plain) | | | | | | 6 |
| 1470100 | Slotted Tube x 55-1/2" (Green) | | | | 4 | 8 | 12 |
| 1470104 | Slotted Tube x 44-1/8" (Blue) | | | 4 | | | |
| 1470105 | Slotted Tube x 44-1/8" (White) | | | 4 | 2 | | |
| 1460048 | Btm Rail x 44-5/8" | 18 | 8 | 8 | | | |
| 1460049 | Btm Rail x 56" | 18 | | | 8 | 8 | |
| 1460050 | Btm Rail x 56" (Yellow) | 18 | 4 | | | | |
| 1460050 | Btm Rail x 56" (Plain) | 18 | | | | | 6 |
| 1460052 | Btm Rail x 56-1/4" (Orange) | 18 | | | 4 | 4 | 8 |
| 1460138 | Btm Rail x 44-5/8" (Blue) | 18 | | 4 | | | |
| 1460033 | Btm Rail x 56-1/4" (Green) | 18 | | | | 4 | 4 |
| 1460105 | Btm Rail x 44-5/8" (White) | 18 | | 4 | 2 | | |
| 1490148 | Esprit Connector | 9 | 12 | 16 | 14 | 16 | 18 |
| 1490545 | Esprit Lower Connector | 10 | 10 | 10 | 10 | 10 | 12 |
| 1490515 | Esprit Side Lower Connector | | 2 | 6 | 4 | 6 | 6 |
| 1184016 | Hardware Pack (Qty. - 59) | 3, 6, 8 | | | | | 1 |
| 1184017 | Hardware Pack (Qty. - 77) | 3, 6, 8 | | 2 | 2 | 2 | 1 |
| 1184034 | Hardware Pack (Qty. - 25) | 3, 6, 8 | | | | | 1 |
| 1920285 | Esprit Frame Assembly | | 1 | 1 | 1 | 1 | 1 |
| 1920582 | Channel Lok II Assembly | | 1 | 1 | 1 | 1 | 1 |
| 1920629 | Bulletin - Concrete Installation | | 1 | 1 | 1 | 1 | 1 |
| 1920644 | Bulletin - Esprit Oval | | 1 | 1 | 1 | 1 | 1 |
| 1920717 | Bulletin - 2 piece connector | | 1 | 1 | 1 | 1 | 1 |

ATLANTIS 48" OVAL - Continued

(Manuf. Name: ESPRIT CHANNEL LOK II)

NB1010 15'x30' Oval

BUTTRESS - FOUND IN MID PACK (3901480620)

| PART # | DESCRIPTION | KEY # | 12 x 18' | 12 x 24' | 15 x 24' | 15 x 30' | 18 x 33' |
|---------|------------------|-------|----------|----------|----------|----------|----------|
| 1440328 | Upright 47-1/2" | 11 | 2 | 6 | 4 | 6 | 6 |
| 1440330 | Diagonal | 12 | 2 | 6 | 4 | 6 | 6 |
| 1320162 | Hold Down Plate | 16 | 2 | 6 | 4 | 6 | 6 |
| 1320152 | Diagonal Bracket | 14 | 2 | 6 | 4 | 6 | 6 |
| 1320154 | Base Plate | 15 | 2 | 6 | 4 | 6 | 6 |
| 1184292 | Hardware Pack | - | 1 | 3 | 2 | 3 | 3 |

STRAPS - FOUND IN STRAP PACK (36153010)

| PART # | DESCRIPTION | KEY # | 12 x 18' | 12 x 24' | 15 x 24' | 15 x 30' | 18 x 33' |
|---------|---------------------|-------|----------|----------|----------|----------|----------|
| 1510132 | 12' Strap x 215.55" | 13 | 1 | 3 | | | |
| 1510133 | 15' Strap x 251.55" | 13 | | | 2 | 3 | |
| 1510134 | 18' Strap x 287.55" | 13 | | | | | 3 |

ATLANTIS 48" (ESPRIT) COMPONENTS FOUND IN WALL - (381530144)

| PART # | DESCRIPTION | 12' | 15' | 18' | 21' | 24' | 27' | 30' A | 30' B |
|---------|---------------------|-----|-----|-----|-----|-----|-----|-------|-------|
| 1382480 | 47" Round Coping | 10 | 12 | 15 | 17 | 19 | 22 | 25 | - |
| 1184201 | 48" Joiner Hardware | 1 | 1 | 1 | 1 | 1 | 1 | 1 | 1 |
| 1920602 | Literature Pack | 1 | 1 | 1 | 1 | 1 | 1 | 1 | - |
| 1182434 | Wall Savor Gasket | 1 | 1 | 1 | 1 | 1 | 1 | 1 | - |

NOTE THE HARDWARE FOUND IN THE FRAME PACK MAY BE AS FOLLOWS:

| | | |
|---------|---------|---------|
| 1184016 | same as | 1184299 |
| 1184017 | same as | 1184300 |
| 1184018 | same as | 1184301 |
| 1184031 | same as | 1184298 |